

Troubleshooting

1. No beep at power-up or no LED light flashing
Is power wire connected to ECU correctly?
Verify the ground connection.
Is buzzer plugged in?
Have you connected the proper reverse light wire?
2. False warning tone or false LED light flashing
Is sensor mounted too low or pointed at the ground?
3. Sensors do not detect any obstacles
Are sensors properly plugged into the correct sockets?

If the problem persists, please follow these steps:

- A. For consumers: contact your dealer or nearby service center
- B. For installer or dealer:
 - 1) Replace the ECU and recheck the system.
 - 2) Test the sensors with certified ECU by using a flat wooden board.
 - 3) Plug the certified sensors into the ECU and recheck.
 - 4) Email your questions to us and we will reply ASAP.

Warranty

I. The unit is warranted for a 1 year period of time from the date of purchase. In the unlikely event of a defect arising in this product when used in accordance with the manufacturer's instructions, the parts will be repaired or replaced free of charge.

I It is required to show the warranty card when making any warranty claims.

I The model and serial number on the unit must be the same as the information on the warranty card.

II. This warranty is non-transferable and is automatically void if:

- I The original purchaser has not completed the warranty card.
- I The unit's serial number is defaced, missing or altered.
- I The unit has been modified or used in a manner contrary to its intended purpose.
- I The unit has been damaged by accident, unreasonable use, neglect, improper installation or service.

III. The warranty does not cover damage to the unit caused by installation or removal of the unit.

Steelmate warranty card

User:	
Tel:	
Vehicle reg No.:	
Product model No.:	
Serial No.:	
Date of installation:	
Name of the distributor	Signed by distributor

Honesty Innovation Passion



Manufactured by:
Steelmate Co., Ltd
<http://www.steel-mate.com>
E-mail: sales@steel-mate.com

All rights reserved
The trademark, patent and copyright owned by Steelmate Co., Ltd.
The right to change design and specification for improving the product is reserved

STEELMATE

PARKING ASSIST SYSTEM

Bumper Fit Sensors

DIGITAL DISPLAY



Manual



Reasons to choose Steelmate

1. Professional manufacturer with super quality
2. Complete range of products, you can choose what you need easily.
3. There are agents/distributors in more than 60 countries, quick response
4. More than 100 engineers in the company, you can enjoy the latest technology.
5. Products have international approvals, quality guaranteed
6. Nearly 20 years leading experience in the automotive industry
7. ISO 9001:2000 and ISO/TS16949:2002 and ISO 14001:2004 certified
8. The National Famous Trademark in the Chinese automotive industry

Important notice

Steelmate parking assist systems help to provide assistance when reversing and parking. Driving skills, such as slowing down, use of mirrors etc. is always essential.

1. This unit is for vehicles with 12V DC only.
2. Unit should be installed by a professional auto technician.
3. Route wiring harness away from heat sources and electrical components.
4. It is strongly advised to check the position of the sensors before the definitive drilling of the holes.
5. Perform test after finishing the installation.

About the product

The parking assist system is an ultrasonic distance monitoring system. It electronically detects the area behind your vehicle while reversing, and alerts you with multiple warning methods. It assists the driver when parking and in manoeuvring situations.

For systems with buzzer only, such as PTS200, PTS300, PTS400, the system beeps once an obstacle is detected behind the car. The closer the obstacle, the quicker the beeps.

For all other models that come with LED displays, apart from an audible warning, the LED indicator changes colour when the distance gets shorter.

If the system has a dual-side LED indicator, the obstacle at the left or right rear of the car will be shown on the corresponding LED indicators. The left or right LED indicator will change colour according to the distance of the obstacle to the left or right rear of the car.

About the product

If the display has digital number indication, such as in display E & J, only the shortest distance will be shown on the display.

For display D, it is designed to be installed at the rear windshield and the distance change can be viewed by the driver from the rear-view mirror.

Every piece of our products has passed the most stringent test before releasing to the market. It is reliable at a wide temperature range (-40°C ~ +85°C) and becomes very useful when you are driving or reversing at a raining day, snowing day or at night. With the help of Steelmate's parking assist system, you can enjoy a convenient and nervous-free driving.

Features

- 1 Sound and/or LED display indicating
- 1 Prevents accidental impact
- 1 Perfect performance in all weather conditions (-40°C~+85°C)
- 1 Does not interfere with the vehicle's electronic system
- 1 Easy installation
- 1 Quality guaranteed

Technical parameters

Detection range:	1/3ft ~ 5ft
Display range:	1ft ~ 5ft
Voltage:	10 ~ 15V
Input:	4W(max)
Temperature:	-40 ~ +85°C
Beeper:	70 ~ 90dB
Sensor installation height:	
Built-in sensor:	1 1/2ft ~ 2ft
stick sensor:	2ft ~ 2 2/3ft

Buzzer only



Buzzer only

Stage	Distance	Warning sound	Remark
1	5ft ~ 3ft	Be----Be----	Safe
2	3ft ~ 2ft	Be-Be-Be-Be-	Slow
3	2ft ~ 1ft	Be—Be—	Stop
4	<1ft	Be——	

Display A



3-colour LED indicator

Stage	Distance	Warning sound	The color of LED indicator	Remark
1	5ft ~ 3ft	Be----Be----	Green	Safe
2	3ft ~ 2ft	Be-Be-Be-Be-	Orange	Slow
3	<2ft	Be—Be—	Red	Stop

Display B



3-colour LED indicator with built-in buzzer

Stage	Distance	Warning sound	The color of LED indicator	Remark
1	5ft ~ 3ft	Be----Be----	Green	Safe
2	3ft ~ 2ft	Be-Be-Be-Be-	Orange	Slow
3	<2ft	Be—Be—	Red	Stop

Display C



4-colour LED indicator

Stage	Distance	Warning sound	The color of LED indicator	Remark
1	5ft ~ 3ft	Be----Be----	Green	Safe
2	3ft ~ 2ft	Be-Be-Be-Be-	Orange	Slow
3	<2ft	Be—Be—	Red	Stop

Display D



3-colour LED indicator with built-in buzzer viewed from rear-view mirror

Stage	Distance	Warning sound	The color of LED indicator	Remark
1	5ft ~ 3ft	Be----Be----	Green	Safe
2	3ft ~ 2ft	Be-Be-Be-Be-	Orange	Slow
3	<2ft	Be—Be—	Red	Stop

Display E



2 side, 4-colour digital LED indicator with built-in buzzer

Stage	Distance	Warning sound	The color of LED indicator	Remark
1	5ft ~ 4ft	Be----Be----	Green	Safe
2	4ft ~ 2ft	Be-Be-Be-Be-	Orange	Slow
3	2ft ~ 1ft	Be—Be—	Red	Stop
4	<1ft	Be——		

Display F



Digital distance and 2-side 3-color LED indicator

Stage	Distance	Warning sound	The color of LED indicator	Remark
1	5ft ~ 3ft	Be---Be---	Green	Safe
2	3ft~2ft	Be-Be-Be-Be-	Orange	Slow
3	<2ft	Be—Be—	Red	Stop

Display J



2-color digital LED display with built-in buzzer

Stage	Distance	Warning sound	The color of LED indicator	Remark
1	5ft ~ 3ft	Be---Be---	Orange	Safe
2	3ft~2ft	Be-Be-Be-Be-		Slow
3	<2ft	Be—Be—	Red	Stop

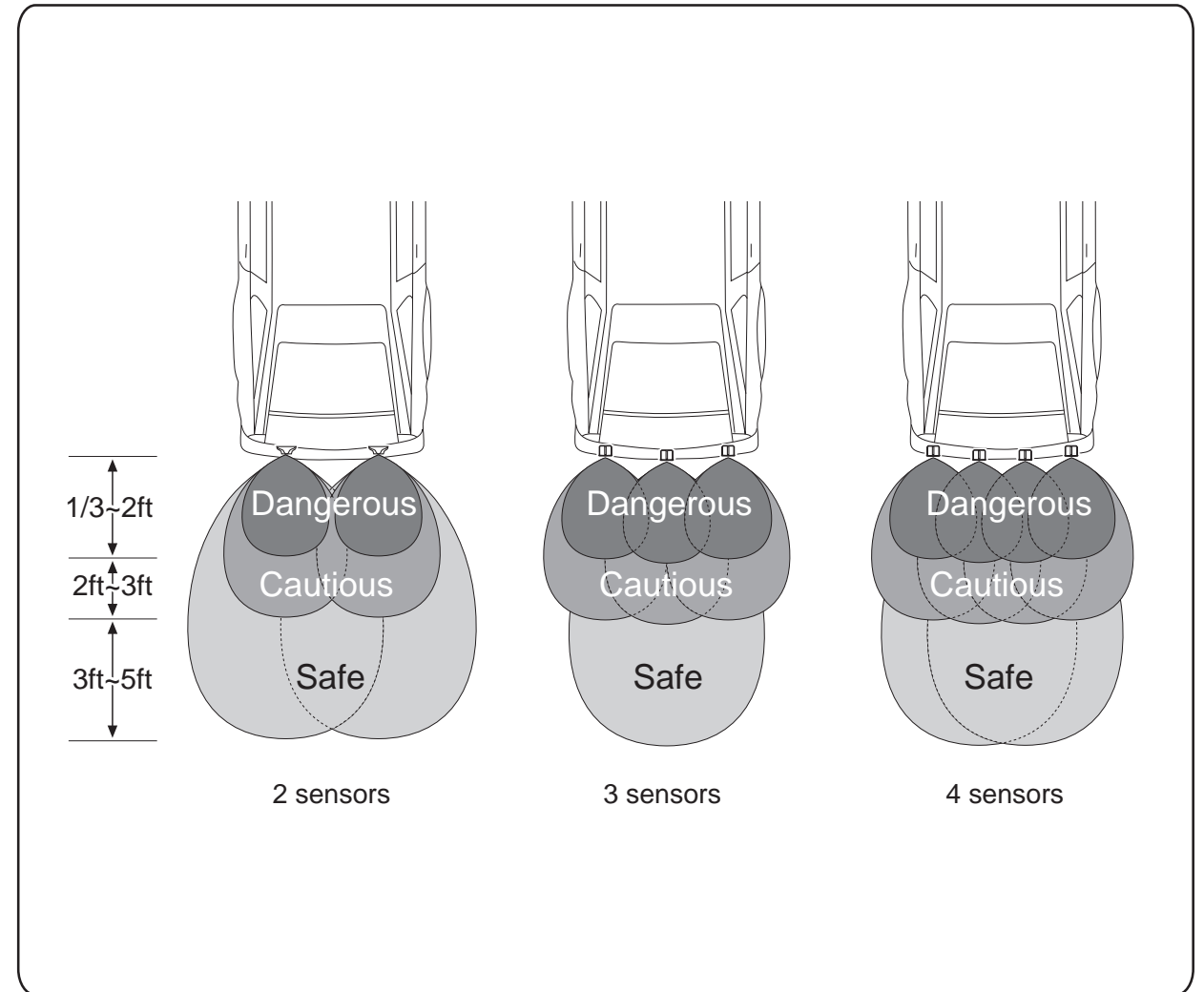

1. Product with buzzer only

For product with buzzer only (such as PTS200, PTS300 and PTS400), the system will beep to warn the car driver if an object is detected behind the car. The closer the distance the quicker the beeps.

2. Product with one LED indicator.

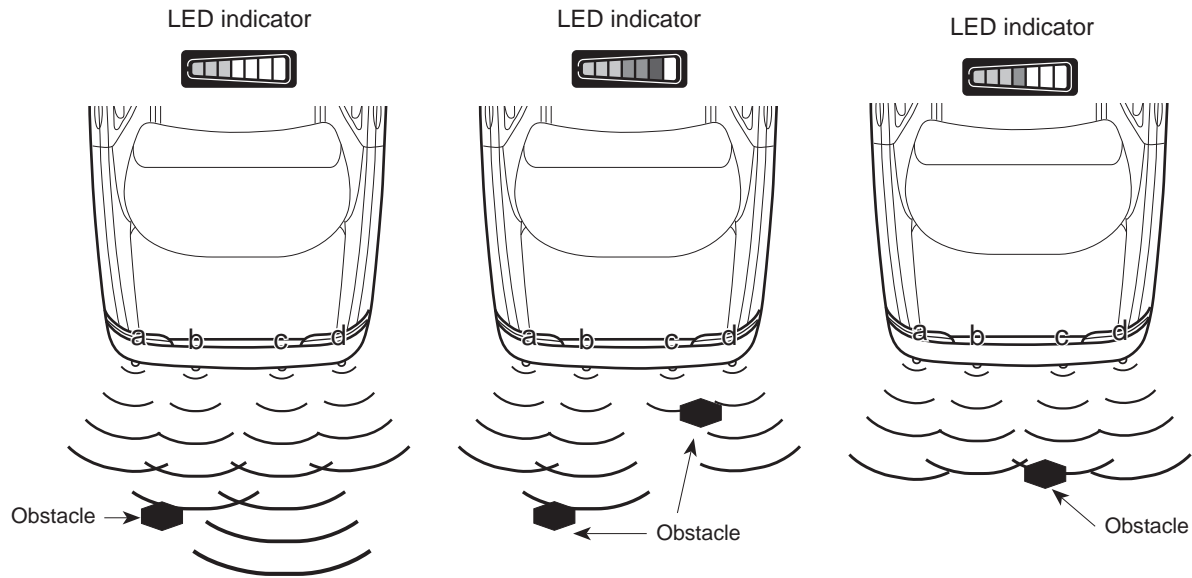

3. Product with a dual-side LED indicator

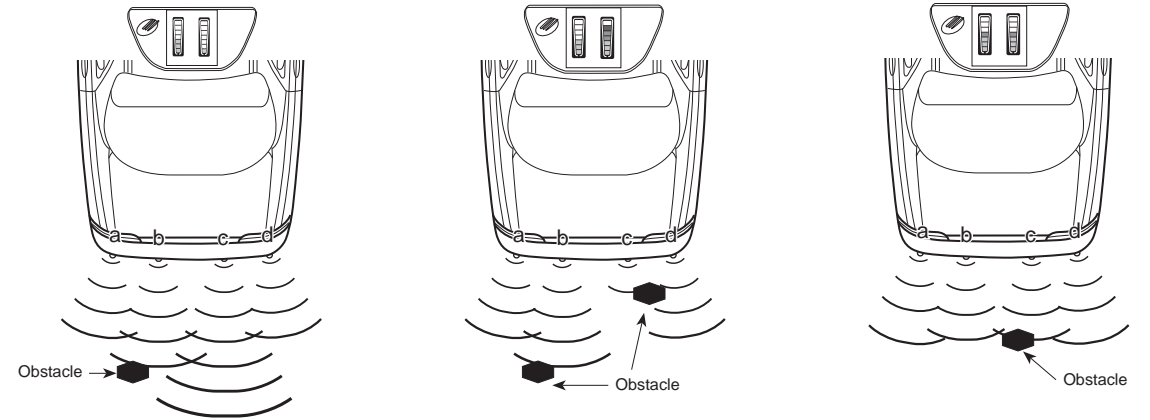

4. Product with a dual-side LED indicator & digital distance indication

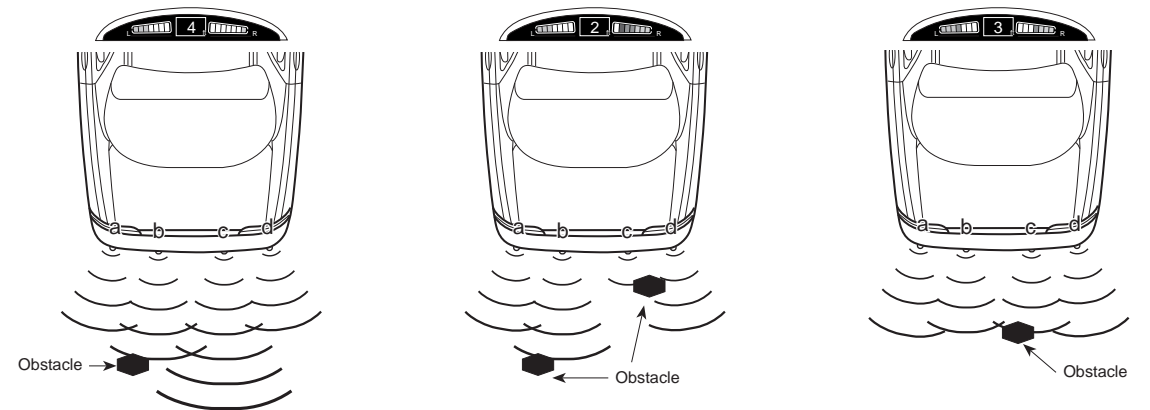

※ If the display with digital distance indication, the shortest distance will be shown on the display.

False detection may occur in the following situations:

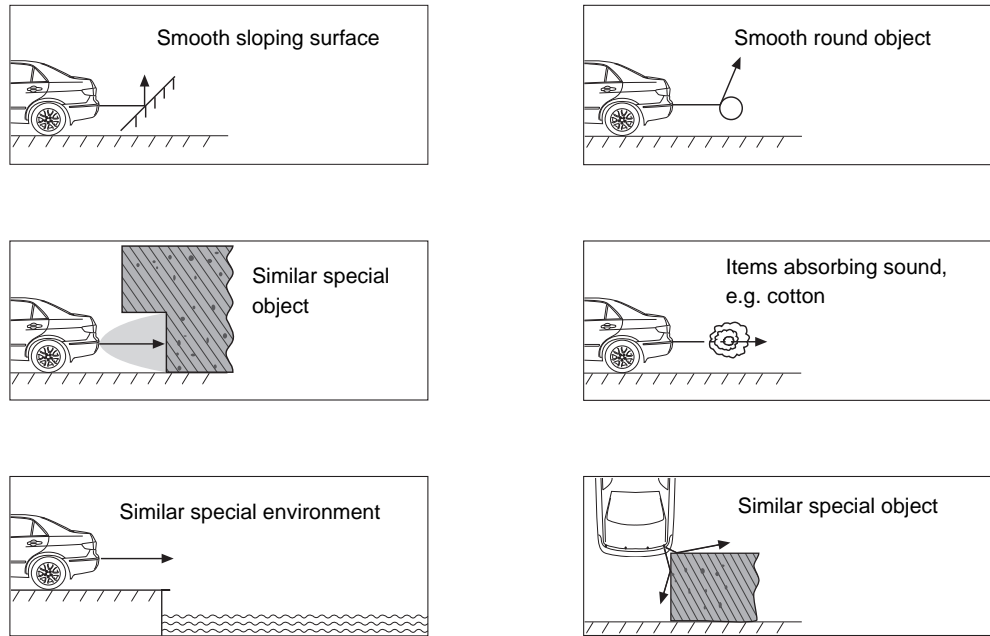

- 1 After installation, fully test the system before use.
- 1 Heavy rain, dirt or a damaged sensor can cause incorrect detection.
- 1 Ensure that the self-testing function is complete and indicates no malfunction before reversing.

The product is a driver assistance device. No warranty as to the operating efficiency of the system or prevention of accidents is guaranteed.

Wire diagram (with buzzer only)

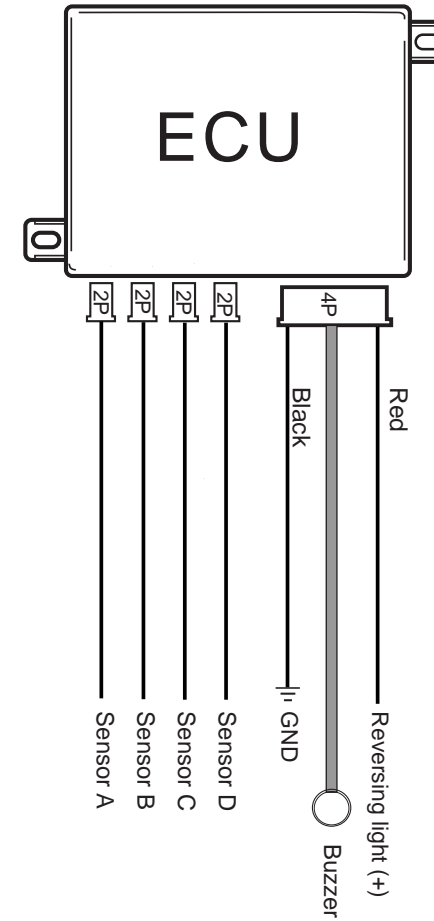

Wire diagram (with buzzer & display)

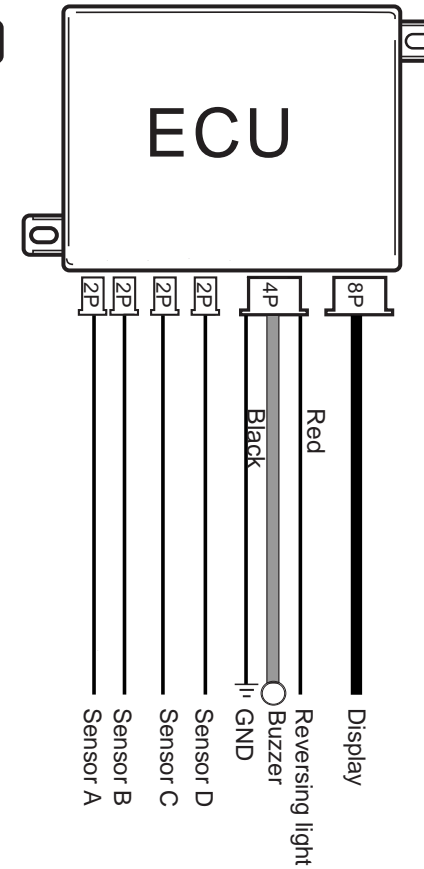

Wire diagram (with display)

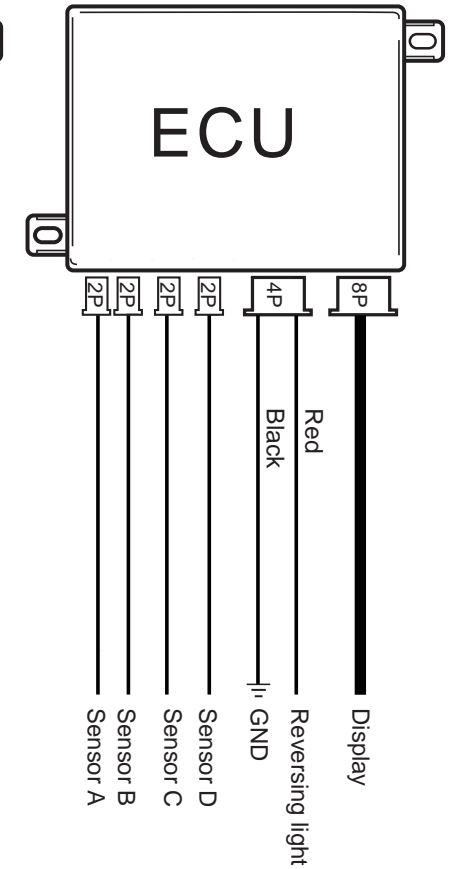

※ Products with 2, 3 or 4 sensors may available

Sensor position

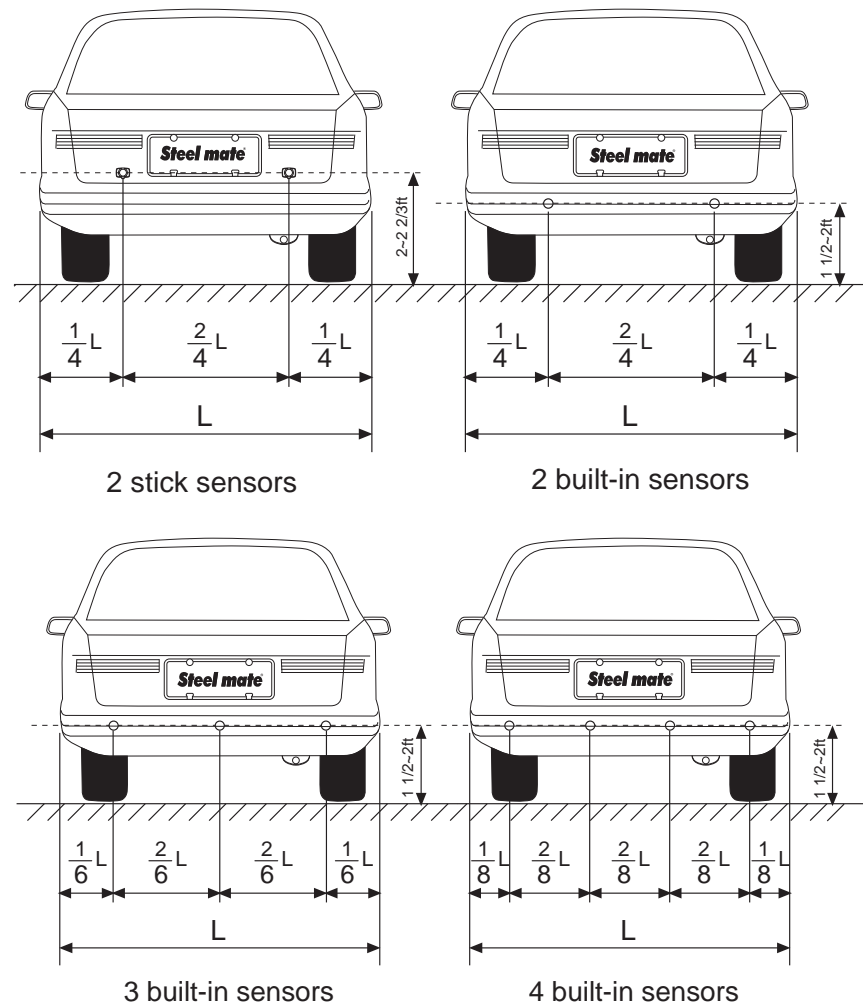

Stick sensor installation

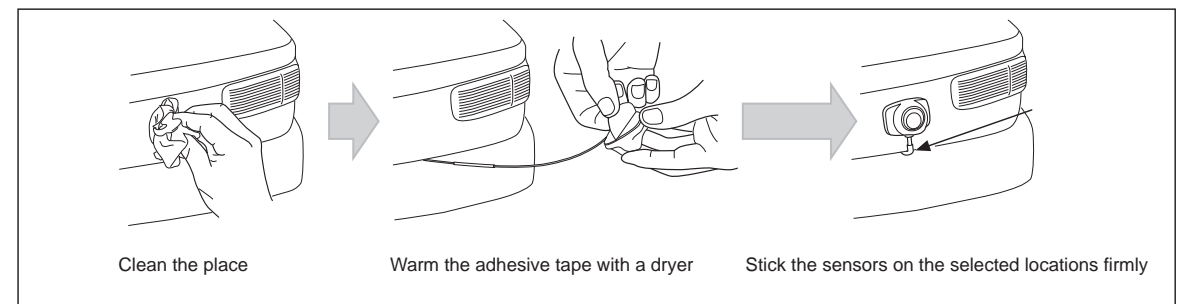
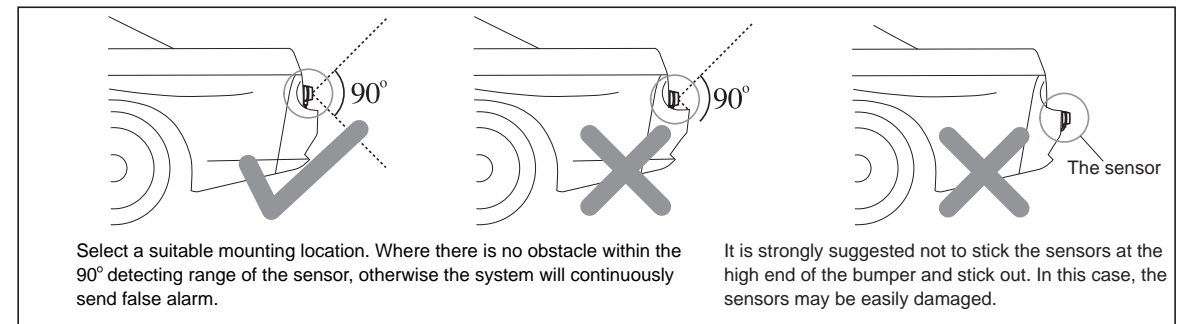
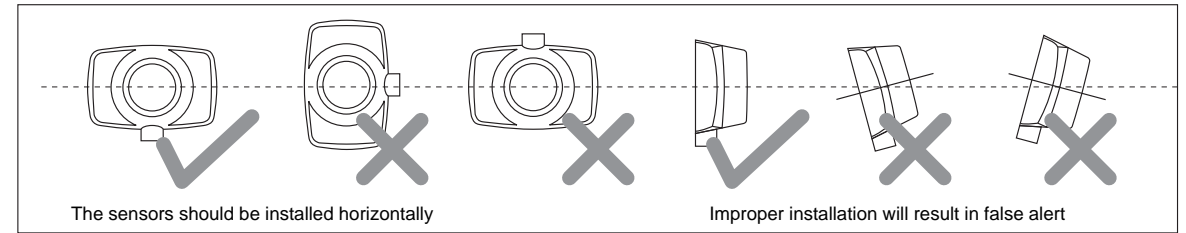

Important note: the sensor should be installed vertically, the "up" sign must be on upside.

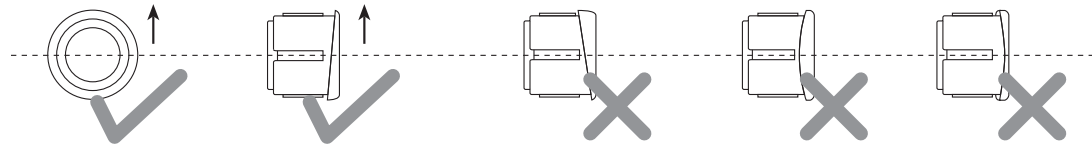

The sensor should be installed vertically

Improper installation will result in false alert

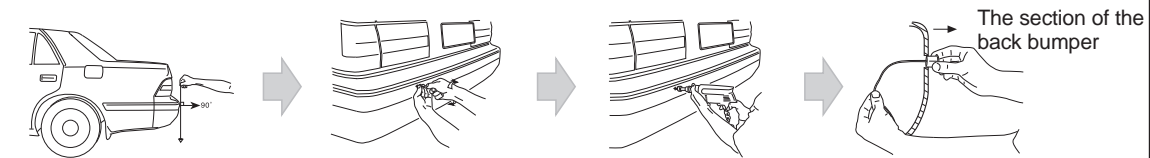

The hole should be vertical

Mark the sensor position with an awl to prevent the electric drill slipping away

Drill a hole on the mark with an electric drill

Push the sensor into the hole firmly.

- ※ Sensor size and shape may vary.
- ※ Some sensors may come with a sensor pad. (designed to help to push the sensor into the hole)

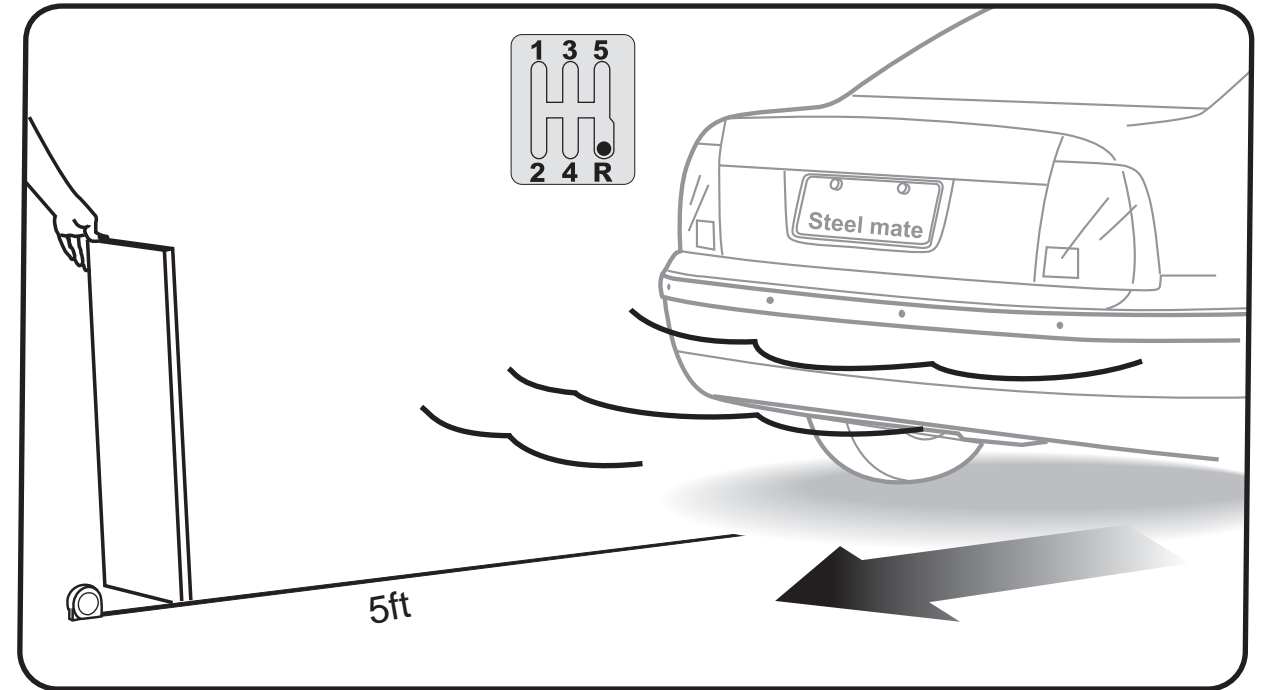

Hold a wooden board (1ft×3 1/3ft) standing behind the car, reverse slowly to test the corresponding functions of the system according to user's manual.